

[illegible]

LEGENDA

TRONCO DE C. CHAMUSCA

→ A CONSTRUÇÃO

EMERSON PATRICK ALVERN
NARTINS, 0445325-351

[illegible]

01/02



PLANTA DE IMPLANTAÇÃO



P 01

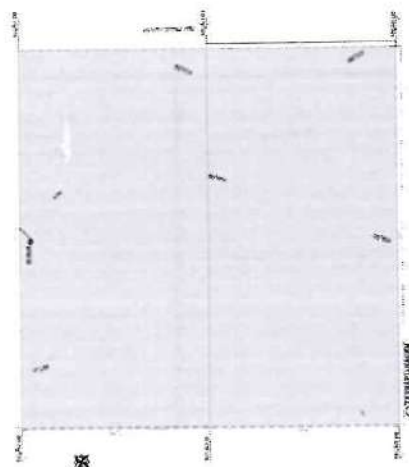
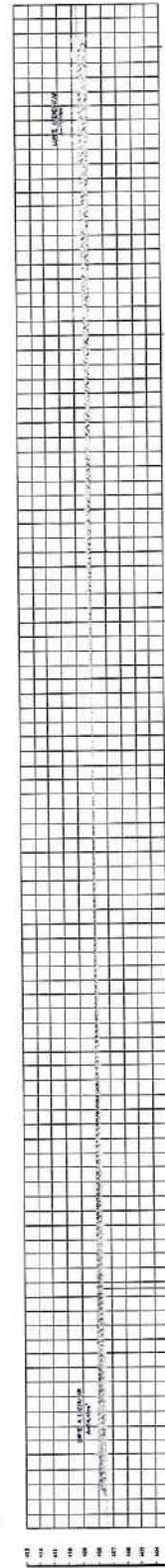
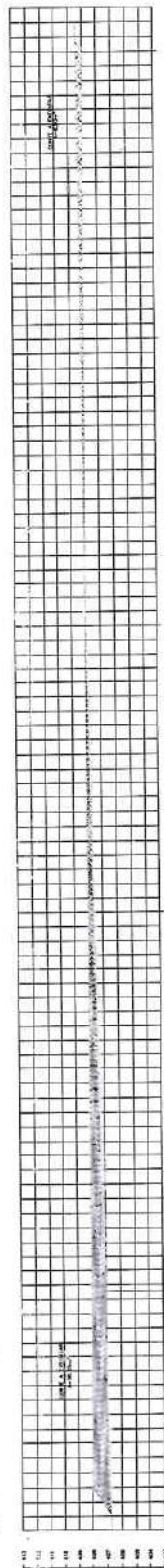
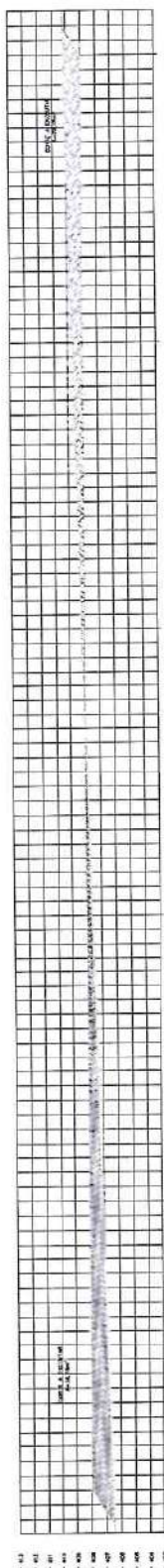

QUANTIDADE DE CUBAGEM DO ATERRIO			
%C02S	AREA (m ²)	DE CUBAGEM (M ³ /M ²)	VOLUME (M ³)
100,2	35,72	9,63	3,43
101	35,64	27,47	2,76
100,2	14,42	8,16	1,18
VOLUME TOTAL DO ATERRIO			7,37

QUANTO DE CUBO DO CONTE			
RECES	AREA (m ²)	NOME AREA (m ²)	VOLUME (m ³)
3009	28.74	0.00	0
3011	4.68	28.74	23.00
3012	15.00	2.50	25.00
VOLUME TOTAL DO CONTE			5.54339

LEGENDA

EMERSON PATRICK ALVENS
MARTINS: 04/63251351

[illegible]

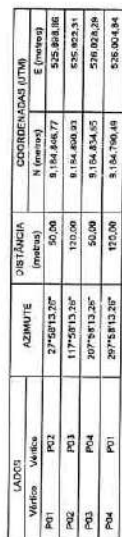

ÁREA (m ²)	4 060,00
PERÍMETRO (m)	340,00
LAJEFAS (Tm)	1,93
HECTARES (ha)	0,6

LEGENDA

LONGHORN HORNED LARK CONVENTION CENTER

Conclusion

EMERSON PATRICK ALVES
MARTINS.04453251351

STATS

CHURCH AND STATE

CHILDREN OF THE FUTURE

1. *Journal of the American Medical Association*, 1990; 263: 1001-1005.

THE UNIVERSITY OF CHICAGO PRESS

DATA	PROJETO	ALPHA	PROJETOS	ALPHA	PROJETOS	ESCALA INDICADA
14/01/2025	CONSTRUÇÃO DE 01 UNIDADE HABITACIONAL					
14/01/2025	PREFEITURA MUNICIPAL DE MAURITI - CE					
14/01/2025	SEDE DO MUNICIPIO DE MAURITI - CE					
14/01/2025	IMPLANTAÇÃO					

INTEGRAL

-PLANTA DE LOCALIZAÇÃO

-PLANTA BAIXA DE IMPLANTAÇÃO / LOCAÇÃO,
1. Exemplo

-QUADRO DE COORDENADAS

JULIO CESAR VILLOTA PORTO



ALPHA

APPROXIMATELY 100,000 PEOPLE ARE CURRENTLY SUFFERING FROM HIV/AIDS IN THE UNITED STATES.

Some of these had previously been reported by other authors. For example, the authors of [1] reported that the mean age of onset of the disease was 12 years, and the mean duration of the disease was 10 years. The authors of [2] reported that the mean age of onset of the disease was 10 years, and the mean duration of the disease was 10 years. The authors of [3] reported that the mean age of onset of the disease was 10 years, and the mean duration of the disease was 10 years.

1

1998

01/02

PRESELENZA DI
MAURITI
CULTURA E STORIA



—BIOGRAPHICAL INFORMATION—



20

EX-100

© 2003 J. All rights reserved.



EMERSON PATRICK ALVES
MARTINS: 04453251351

[illegible]

DATA OUTUBRO/2025	PROJETO ALPHA	PROJETOS ALPHA	EDICION ALPHA	PROJETOS ALPHA	ESCALA INDICADA
CONSTRUÇÃO DE 01 UNIDADE HABITACIONAL					
PREFEITURA MUNICIPAL DE MAURITI - CE					
SEDE DO MUNICIPIO DE MAURITI-CE					
TERRAPLENAGEM					
ASSINADO					
ENDEREÇO/CI/CE					
PROPRIETÁRIO					
OBJETO					

CONTEÚDO

PRÁTICA

02/02

- PROJETO DE TERRAPLENAGEM (ATERRO)

- LEGENDA

LEGENDA

MATCH	ESPECIFICAÇÃO
22/5	ATERRO A EXECUTAR ESSO 0,20m
	PLATO

PLANTA BAIXA
ESCALA 1/400

PROJETO DESENHADO POR:

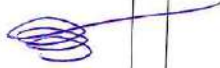

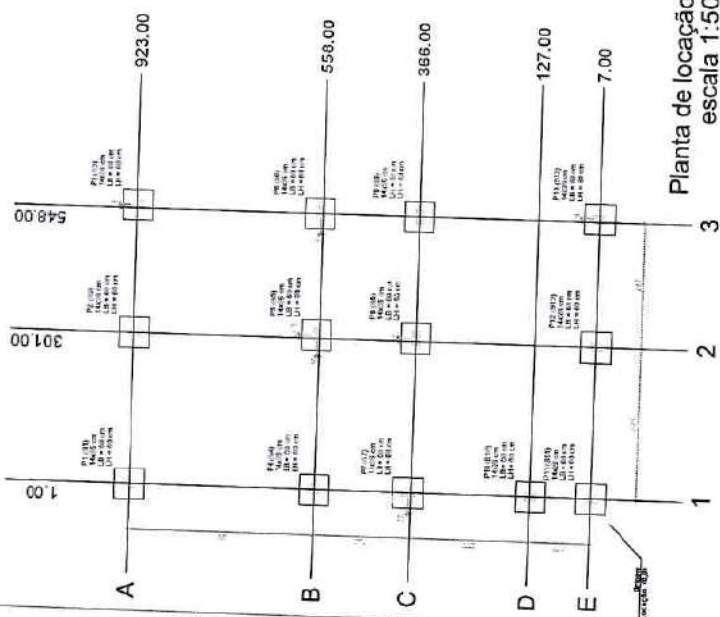

Planta de locação
escala 1:50

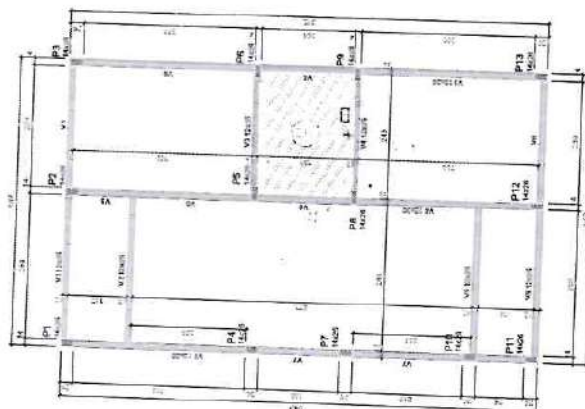

Forma do pavimento Nivel 1 Teto (Nível 265)
escala 1:50

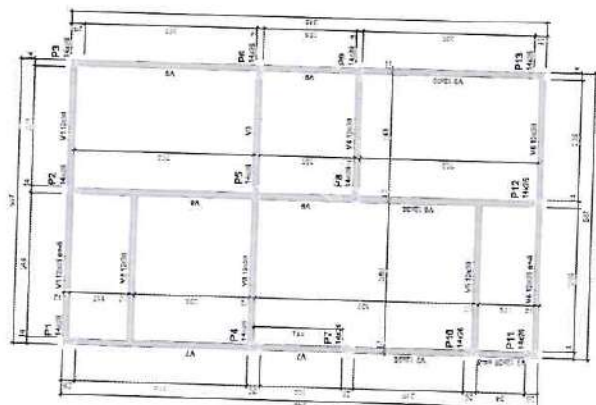

Forma do pavimento Nivel 0 Baldr (Nível -5)
escala 1:50



Corte Y-Y
Esquemático
escala 1:100

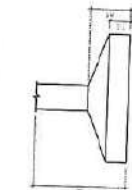

Item	Descrição	Quantidade	Valor Unitário	Valor Total
1
2
3
4
5
6
7
8
9
10
11
12
13
14
15
16
17
18
19
20
21
22
23
24
25
26
27
28
29
30
31
32
33
34
35
36
37
38
39
40
41
42
43
44
45
46
47
48
49
50
51
52
53
54
55
56
57
58
59
60
61
62
63
64
65
66
67
68
69
70
71
72
73
74
75
76
77
78
79
80
81
82
83
84
85
86
87
88
89
90
91
92
93
94
95
96
97
98
99
100

Item	Descrição	Quantidade	Valor Unitário	Valor Total
1
2
3
4
5
6
7
8
9
10
11
12
13
14
15
16
17
18
19
20
21
22
23
24
25
26
27
28
29
30
31
32
33
34
35
36
37
38
39
40
41
42
43
44
45
46
47
48
49
50
51
52
53
54
55
56
57
58
59
60
61
62
63
64
65
66
67
68
69
70
71
72
73
74
75
76
77
78
79
80
81
82
83
84
85
86
87
88
89
90
91
92
93
94
95
96
97
98
99
100

Item	Descrição	Quantidade	Valor Unitário	Valor Total
1
2
3
4
5
6
7
8
9
10
11
12
13
14
15
16
17
18
19
20
21
22
23
24
25
26
27
28
29
30
31
32
33
34
35
36
37
38
39
40
41
42
43
44
45
46
47
48
49
50
51
52
53
54
55
56
57
58
59
60
61
62
63
64
65
66
67
68
69
70
71
72
73
74
75
76
77
78
79
80
81
82
83
84
85
86
87
88
89
90
91
92
93
94
95
96
97
98
99
100

Item	Descrição	Quantidade	Valor Unitário	Valor Total
1
2
3
4
5
6</

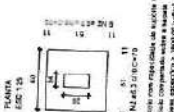
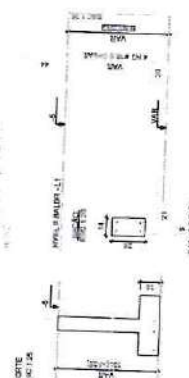

total com capacidade do recipiente = 3.000 kg/m³ e sendo considerada sobre a mesma uma capacidade = 1000 kg/m³.

CONFIDENTIAL

For the purpose of this study, the following hypotheses were formulated:

Made in Canada
 P.C. CANADA
 100% RECYCLED PAPER

Novo PAC FHNIS Sub.50

PROJETO ESTRUTURAL

PLANTA DE ARMADURAS
NÍVEL 0 - BALDRAMÉ

Desenho: 001
Escala: Indica
Revisão: 01
Data: 09/05/2016

CAIXA

^a Abbreviations used are as given in the preceding paper.¹

1. $\frac{1}{2} \times \frac{1}{2} = \frac{1}{4}$ (probability of getting two heads)
 2. $\frac{1}{2} \times \frac{1}{2} = \frac{1}{4}$ (probability of getting two tails)
 3. $\frac{1}{2} \times \frac{1}{2} = \frac{1}{4}$ (probability of getting one head and one tail)
 4. $\frac{1}{2} \times \frac{1}{2} = \frac{1}{4}$ (probability of getting one tail and one head)

